

## Manual projection screen

■ Vivid picture

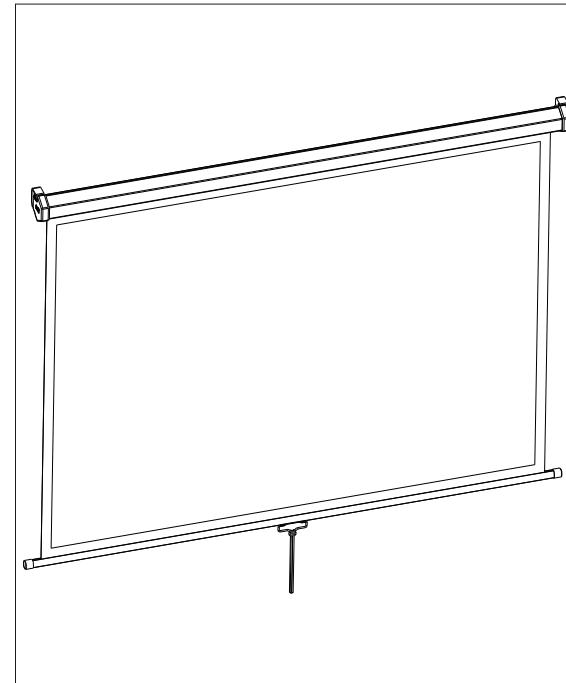

■ Easy installation

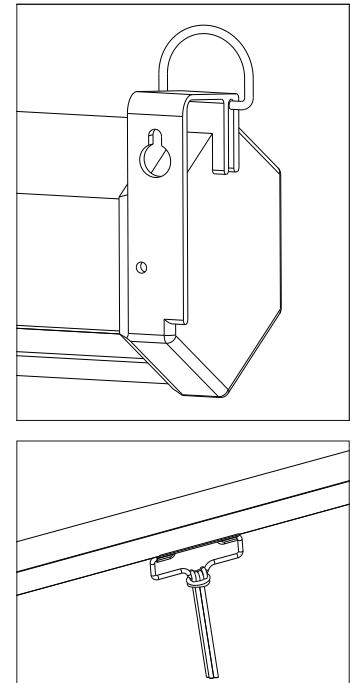

### INSTALLATION AND OPERATING INSTRUCTIONS FOR MANUAL SCREEN

Easy operation, offering vivid and clear pictures, suitable for cinema purposes, entertainment, pubs, clubs, multimedia classrooms, and conference rooms.

Factory has obtained ISO9001:2000 certificate, CE certificate, products were passed ROHS Testing.

😊 Thank you for choosing to use manual projection screen, for your using the screen more secure, please read the manual instruction carefully before using.

### User's operation instructions

- ☆ The ceiling or the wall which will be used to be fixed the screen must have enough holding capacity to operate the manual screen.
- ☆ The screen's place should be fixed the best view of the customers. And when the screen be full expanded, the bottom should higher than the head of customers. Exactly fixed and using will delay the life of screen.
- ☆ The dust or dirty scratching will be effect the projection images, so please notes:
  - 1) Do not touch the surface of the screen with your hands.
  - 2) Do not scratch or write on the surface of the screen.
  - 3) Use a cotton cloth or a soft dust brush to remove dust.
  - 4) Do not use Corrosives cleanser to clear the surface of screen.
- ☆ When not in use, please raise the screen into screen housing.

### Products Features

- ☆ **Fashionable and graceful model**  
Simple structures, graceful model, adopt the metal material, concise and fashion.
- ☆ **Special self-locking system, convenient stretching**  
Manual self-locking system, fold and unfold freely, can stop at any position, only need pull gently, the screen will roll back to the case.
- ☆ **Scientific and easy Installation**  
Mount the screen to a wall by placing thick screws into the mounting holes. Alternatively mount the screen to the ceiling by using the two available steel hooks.
- ☆ **Vivid picture**  
Adopt classic fabric of Matte white, Glass beaded., they can provide different Gain and Viewing angle, which suitable for different places. Matte white can offers the best and large viewing angle, which can make the picture clear and vivid; Glass beaded offers high gain, and the projected picture is colorful and vivid.
- ☆ **Location**  
Suited for using in meeting rooms, business affairs, casino place, club, multimedia classroom, minitype cinema, home theater, government institution or other entertainment sites.

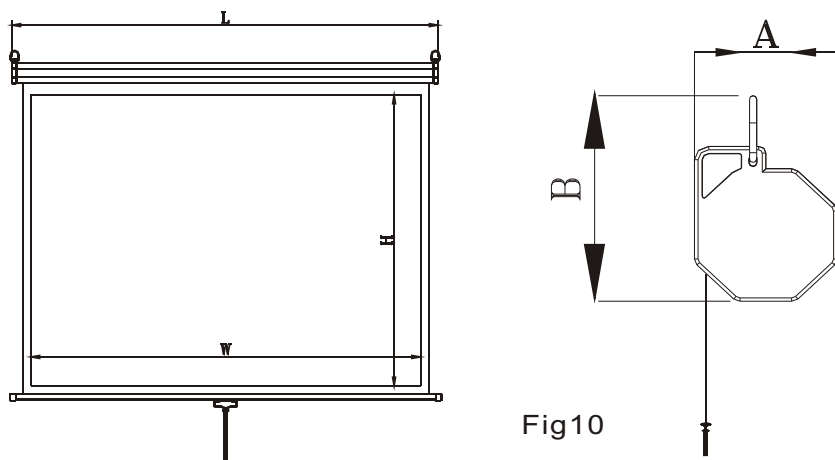
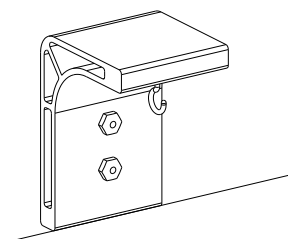

Fig10

### Optional Accessories



Bracket

### Notes

- ☆ The projection screen with a unique self-locking device, when you stretched the screen down, the screen will go to the appropriate location when you leave go of, then the device will lock the screen. When once again pull the screen down, the device reset, after you leave go of, then the screen roll back to the volume box.
- ☆ Please check the screen surface before the fabric roll back to the metallic housing, to ensure that no dust, no insects and foreign matter in order to roll back to avoid screen damage.
- ☆ The screen roll back to the volume box, the speed may appear too fast, resulting in the phenomenon of the handle impact the housing. Please gently pull the handle, let the speed slowed down to avoid the damage to other components

### Installation way

#### ☆ Wall mount installation

As picture 1, let the screw through the key hole of the side cover, after the installation, please confirm if it solid or not.

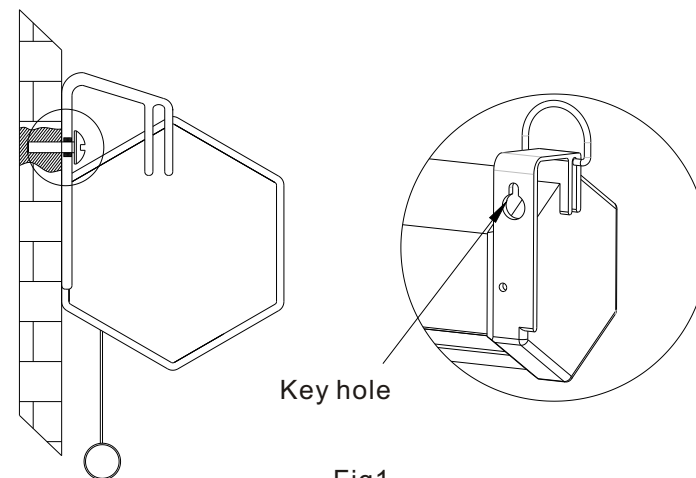

Fig1

#### ☆ Ceiling installation

As picture 2, after confirm the screws linked to firmly, let the "D"-type rings hanging on the ceiling link.

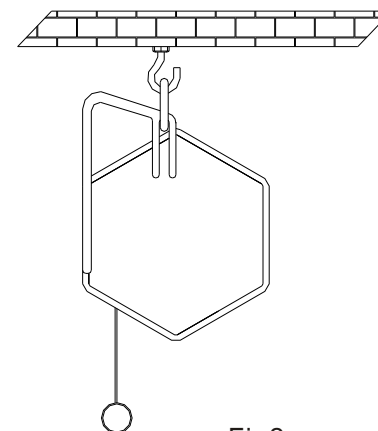

Fig2

### ☆ Wall bracket installation:

Refer to Fig.3; it is strongly recommend using the professional bracket, before installation, firstly drawing a horizontal line, ensuring the screen on the same horizontal line.

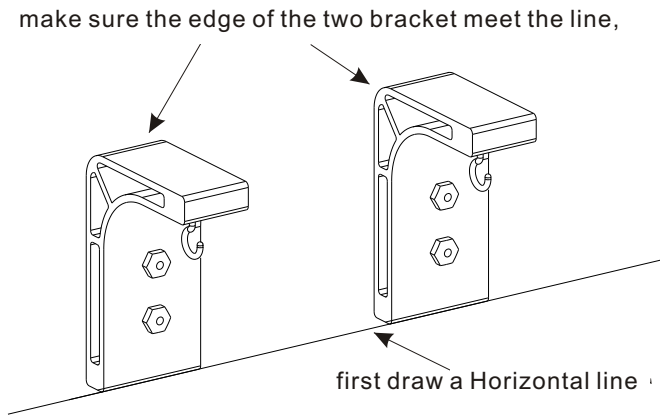

Fig.3

### ☆ Invisible installation

Refer to Fig.4, Invisible installation must has enough space to hidden the projection screen.

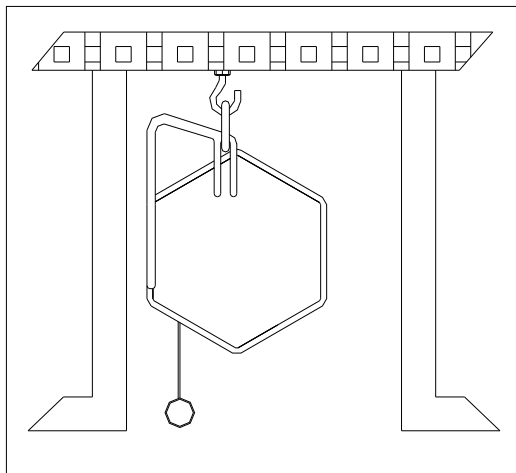

Fig.4

### Data of screen

Table 1 format 1:1

Type	Size	Viewing area W*H	Install distance	Length	Cover size (L*A*B)	Pack size (L*W*H)
Manual screen	60"*60"	1520*1520	1645	1665	1665*90*100	1740*127*107
	70"*70"	1770*1770	1895	1915	1915*90*100	1990*127*107
	84"*84"	2070*2070	2195	2215	2215*90*100	2290*127*107
	96"*96"	2360*2360	2505	2525	2525*90*100	2600*127*107

Table 2 format 16:9

Type	Size	Viewing area W*H	Install distance	Length	Cover size (L*A*B)	Pack size (L*W*H)
Manual screen	72"	1590*890	1715	1735	1735*90*100	1810*127*107
	84"	1860*1040	1985	2005	2005*90*100	2080*127*107
	92"	2030*1140	2155	2175	2175*90*100	2250*127*107
	100"	2210*1240	2355	2375	2375*90*100	2450*127*107
	120"	2650*1490	2795	2815	2815*90*100	2890*127*107

Table3 format 4:3

Type	Size	Viewing area W*H	Install distance	length	Cover size (L*A*B)	Pack size (L*W*H)
Manual screen	72"	1460*1090	1585	1605	1605*90*100	1680*127*107
	84"	1700*1280	1825	1845	1845*90*100	1920*127*107
	92"	1860*1400	2005	2025	2025*90*100	2100*127*107
	100"	2030*1520	2175	2195	2195*90*100	2270*127*107
	120"	2430*1820	2575	2595	2595*90*100	2670*127*107

The above parameters are subject to change without notice, please refer to Fig.10