

Philips OLED 9 series
4K UHD Android TV -
Bowers&Wilkins Sound
with Ambilight 4-sided

Sound by Bowers & Wilkins

139 cm (55") Ambilight TV
P5 AI Perfect Picture Engine
Android TV / AI voice control



55OLED935

Breathtaking picture. Cinematic sound.

4K UHD OLED Android TV

Give your movies the TV they deserve. This stunning Philips OLED+ TV boasts up-firing Bowers & Wilkins speakers, and the latest P5 picture processing with AI. You get a lifelike picture and thrilling sound with crystal-clear dialogue.

Designed to thrill.

- Philips OLED+ TV with HDR. The difference is real.
- The magic of Ambilight. Only from Philips.
- Immersive sound. Bowers & Wilkins meets Dolby Atmos.
- Kvadrat speaker cloth. Muirhead leather-backed remote

Incredible picture. Bowers & Wilkins sound.

- P5 engine with AI. Whatever you watch, a picture so real.
- Dolby Vision and Dolby Atmos. Cinematic vision and sound.
- 3.1.2 sound system. Up-firing speakers for Dolby Atmos.
- Integrated sub-woofer and full-range drivers.
- Separate central tweeter for pristine dialogue.

Content at your command.

- Android TV. Simply smart.
- Voice control. Google Assistant built-in. Works with Alexa.
- DTS Play-Fi. Multi-room audio.

PHILIPS

4K UHD Android TV - Bowers&Wilkins Sound

Sound by Bowers & Wilkins 139 cm (55") Ambilight TV, P5 AI Perfect Picture Engine, Android TV / AI voice control

Highlights

Sound by Bowers & Wilkins

An exclusive speaker design by legendary audio engineers Bowers & Wilkins delivers thrillingly lifelike performance. Up-firing speakers let you get the most out of Dolby Atmos. A central tweeter keeps the dialogue pristine no matter how intense the drama gets.

Ambilight 4-sided

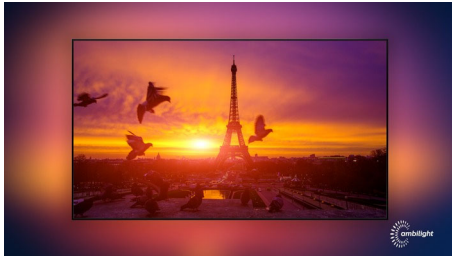

With Philips 4-sided Ambilight, every moment feels closer. Intelligent LEDs around the edge of the TV respond to the on-screen action and emit an immersive glow that's simply captivating. Experience it once and wonder how you enjoyed TV without it.

P5 engine with AI



Philips P5 processor with AI delivers a picture so real it feels like you could step right into it. A deep-learning AI algorithm processes images in a manner similar to the human brain. No matter what you're watching, you get lifelike

detail and contrast, rich color, and smooth motion.

Philips OLED+ TV

A Philips 4K UHD OLED+ TV is compatible with all major HDR formats. Whether it's a must-watch series or the latest video game, shadows will be deeper. Bright surfaces will shine. Colors will be truer. Motion is incredibly smooth.

Tactile harmony

Premium materials make all the difference to your Philips TV. Kvadrat's acoustically transparent wool-blend speaker fabric allows the sound to flow freely into the room. Responsibly sourced Muirhead leather and backlit keys add a sophisticated finish to the remote control.

Android TV

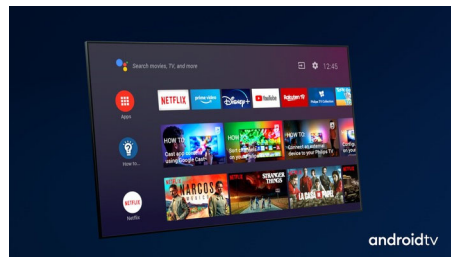

Your Philips Android TV gives you the content you want when you want it. You can customize the home screen to display your favorite apps, making it simple to start streaming the movies and shows you love. Or pick up where you left off.

55OLED935/12

Voice assistant

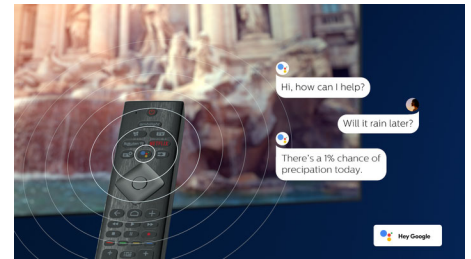

Control your Philips Android TV with your voice. Want to play a game, watch Netflix, or find content and apps in the Google Play store? Just tell your TV. You can even command all Google Assistant-compatible smart home devices, like dimming the lights and setting the thermostat on movie night. Without leaving the sofa. The days of searching for the TV remote are over. Now you can use your voice to control your Philips smart TV via Alexa-enabled devices, like Amazon Echo. Turn your TV on, change the channel, switch to your gaming console and more with Alexa.

DTS Play-Fi

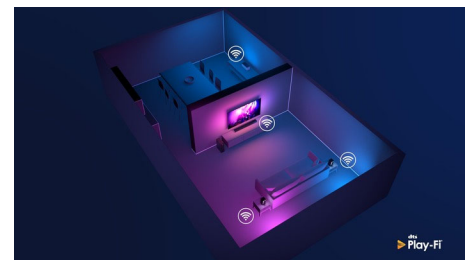

With DTS Play-Fi on your Philips TV you can connect to compatible speakers in any room. Got wireless speakers in the kitchen? Listen to the movie while you make a snack, or keep up with the sports commentary while you get everyone a drink.



OLED+

Sound by
Bowers & Wilkins

P AI Intelligent
Dual Picture Engine

ULTRAHD™
PREMIUM

Dolby Vision Atmos

androidtv

Hey Google

4K UHD Android TV - Bowers&Wilkins Sound

Sound by Bowers & Wilkins 139 cm (55") Ambilight TV, P5 AI Perfect Picture Engine, Android TV / AI voice control

Specifications

Ambilight

- Ambilight Version: 4-sided
- Ambilight Features: Built in Ambilight+hue, Ambilight Music, Game Mode, Wall colour adaptive, Lounge mode, AmbiSleep, Sunrise Alarm

Picture/Display

- Display: 4K Ultra HD OLED
- Diagonal screen size: 55 inch / 139 cm
- Panel resolution: 3840x2160
- Aspect ratio: 16:9
- Pixel engine: P5 AI Perfect Picture Engine
- Picture enhancement: Ultra Resolution, Wide Color Gamut 99% DCI/P3, Dolby Vision, HDR10+, Perfect Natural Motion, 6600 PPI, Super Resolution

Supported Display Resolution

- Computer inputs on all HDMI: up to 4K UHD 3840x2160 @60Hz, HDR supported, HDR10+/HLG, HDR supported, HDR10/ HLG
- Video inputs on all HDMI: up to 4K UHD 3840x2160 @60Hz, HDR supported, HDR10/HLG (Hybrid Log Gamma), HDR10+/Dolby Vision

Android TV

- OS: Android TV™ 9 (Pie)
- Pre-installed apps: Google Play Movies*, Google Play Music*, Google Search, YouTube, BBC iPlayer, Netflix, Amazon Prime Video
- Memory size(Flash): 16GB*

Smart TV Features

- Interactive TV: HbbTV
- Program: Pause TV, USB recording*
- Ease of Installation: Auto detect Philips devices, Device connection wizard, Network installation wizard, Settings assistant wizard
- Ease of Use: One-stop smart menu button, Onscreen usermanual
- Firmware upgradeable: Firmware auto upgrade wizard, Firmware upgradeable via USB, Online firmware upgrade
- Screen Format Adjustments: Basic - Fill Screen, Fit to screen, Advance - Shift, Zoom, stretch, Wide screen
- Remote Control: with Voice, with Key light, with Muirhead leather
- User Interaction: SimplyShare
- Voice assistant*: Google Assistant built-in, RC with

Mic., Works with Alexa

Processing

- Processing Power: Quad Core

Tuner/Reception/Transmission

- HEVC support
- Digital TV: DVB-T/T2/T2-HD/C/S/S2
- MPEG Support: MPEG2, MPEG4
- Video Playback: PAL, SECAM
- TV Program guide*: 8 day Electronic Program Guide
- Signal strength indication
- Teletext: 1000 page Hypertext

Connectivity

- Number of HDMI connections: 4
- Number of USBs: 2
- Wireless connections: Bluetooth 4.2, Wi-Fi 802.11ac, 2x2, Dual band
- Other connections: Common Interface Plus (CI+), Digital audio out (optical), Ethernet-LAN RJ-45, Headphone out, Satellite Connector, Service connector
- HDMI features: 4K, Audio Return Channel
- EasyLink (HDMI-CEC): Remote control pass-through, System audio control, System standby, One touch play
- HDCP 2.3: Yes on all HDMI

Multimedia Applications

- Video Playback Formats: Containers: AVI, MKV, H264/MPEG-4 AVC, MPEG-1, MPEG-2, MPEG-4, WMV9/VC1, VP9, HEVC (H.265)
- Subtitles Formats Support: .SRT, .SUB, .TXT, .SMI
- Music Playback Formats: AAC, MP3, WAV, WMA (v2 up to v9.2), WMA-PRO (v9 and v10)
- Picture Playback Formats: JPEG, BMP, GIF, PNG, 360 photo, HEIF

Power

- Mains power: AC 220 - 240 V 50/60Hz
- Standby power consumption: <0.3W
- Off mode power consumption: N/A W
- Ambient temperature: 5 °C to 35 °C
- Power Saving Features: Auto switch-off timer, Light sensor, Picture mute (for radio), Eco mode
- Energy Label Class: B
- Eu Energy Label power: 159 W
- Annual energy consumption: 233 kW h

55OLED935/12

- Mercury content: 0 mg
- Presence of lead: Yes*

Sound

- Audio: Sound by Bowers & Wilkins, 3.1.2 Channel, Output power : 70 Watt (RMS)
- Codec: AC-4, Dolby Atmos, Dolby Digital MS12 V2.3, DTS-HD(M6)
- Speaker configuration: 10W x2, 5W x1, woofer 20W, height 12.5W x2
- Sound Enhancement: 5 Band Equalizer, A.I. Sound, Clear Dialogue, Dolby Atmos, Dolby Bass Enhancement, Dolby Volume Leveler, Night mode, Auto Volume Leveler, Bass Enhancement

Dimensions

- Box dimensions (W x H x D): 1400.0 x 953.0 x 174.0 mm
- Set dimensions (W x H x D): 1227.8 x 705.6 x 49.3 mm
- Set dimensions with stand (W x H x D): 1227.8 x 805.5 x 260.7 mm
- Product weight: 21.0 kg
- Product weight (+stand): 28.1 kg
- Weight incl. Packaging: 32.7 kg
- Stand dimensions (W x H x D): 880.0 x 104.1 x 260.7 mm
- VESA wall mount compatible: 300 x 300 mm

Design

- Colors of TV: Gun metal gray frame
- Stand design: Dark chrome sound solution



Connections

Side

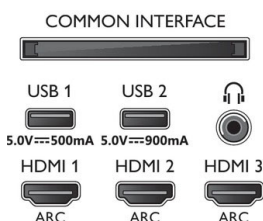

Bottom

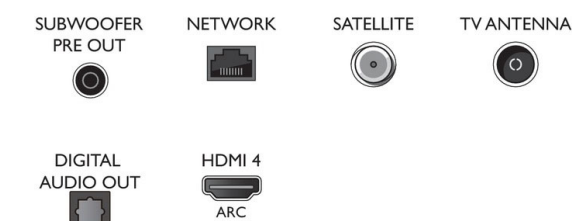

Issue date 2020-08-21

Version: 5.2.1

12 NC: 8670 001 65511
EAN: 87 18863 02277 1

© 2020 Koninklijke Philips N.V.
All Rights reserved.

Specifications are subject to change without notice.
Trademarks are the property of Koninklijke Philips N.V.
or their respective owners.

www.philips.com

* EPG and actual visibility (up to 8 days) is country and operator dependent.

* Android App offerings vary per country. For more details please visit your local Google Play Store.

* Energy consumption in kWh per year, based on the power consumption of the television operating 4 hours per day for 365 days. The actual energy consumption will depend on how the television is used.

* Philips TV Remote app and related functionalities vary per TV model, operator, and country, as well as smart device model and OS. For more details please visit: www.philips.com/TVRemoteapp.

* Smart TV app offerings vary per TV model and country. For more details please visit: www.philips.com/smarttv.

* USB recording for digital channels only, recordings may be limited by broadcast copy protection (CI+). Country and channel restrictions may apply.

* This television contains lead only in certain parts or components where no technology alternatives exist in accordance with existing exemption clauses under the RoHS Directive.

* Its functionality is subject to ChromeCast built-in apps and smart devices. For more details, please visit ChromeCast built-in product pages.

* *Memory size (Flash) : 16G, the actual available disc space may differ (dependant on e.g. (pre-)installed apps, installed operating system, etc.)